

SECURITY DISTANCES

- From NOT combustible object :
 - A > 400 mm B > 100 mm C > 100 mm
- From combustible object and from principal wall in rein forced concrete :
 - A > 800 mm B > 250 mm C > 250 mm
- The minimal distance between the appliance and every flammable object around it is 1.5 meter.

These are the measures in mm of different equipments models Right. For Left models use the same measures speculates.

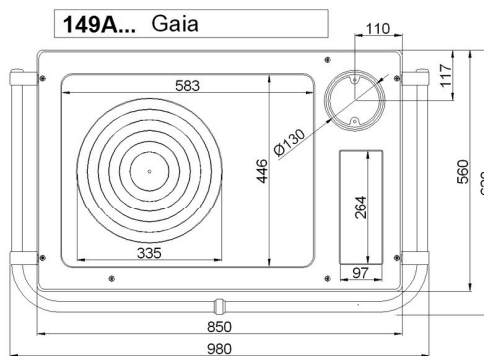
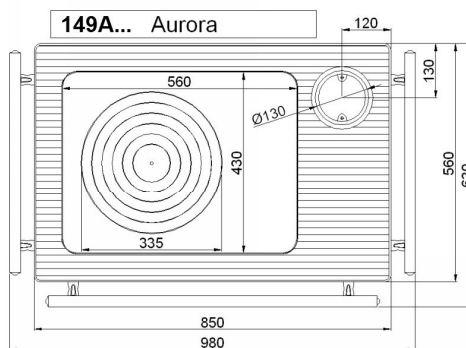
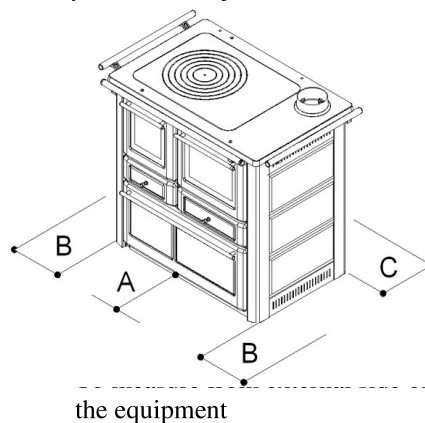
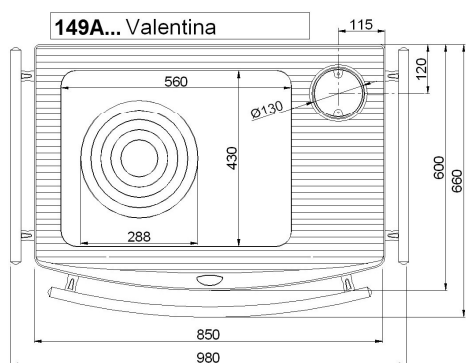

Equipment weight				
	SERIE	149A		
	TYP	AURORA	VALENTINA	GAIA
Model				
VISIBLE RIGHT VISIBLE LEFT	kg	150	155	140
VIS. RIGHT L CERAMIC VIS. LEFT L CERAMIC	kg	160	-	150
VIS. RIGHT L SOAP STONE VIS. LEFT L SOAP STONE	kg	174	-	164

MEASUREMENTS FOR REAR SMOKE EXHAUST (Ø130)

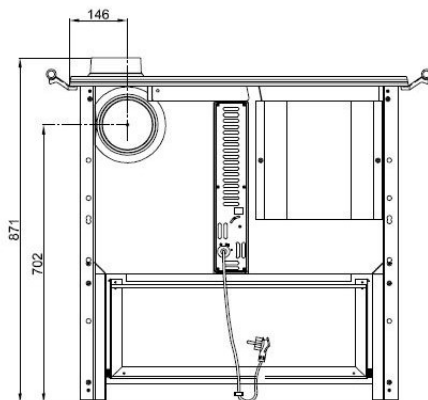

149A ... DX

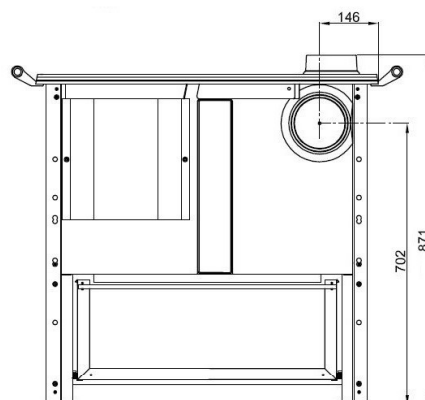

149A ... SX

1.4 Connection

- Before connection check technical data reported in the technical plate (Chap. 4) and control that it correspond to the ones required in the order.
- All heating biomass equipment especially wood appliance has to evacuate the combustion products in a flue built in conformity with normative in force.
- The following instructions describes „ informations for a good installation „, and it refers to a normative in force but it are not to be consider exhaustive for installations laws.

COLLAR EXHAUST FUMES ASSEMBLY

The equipment is provided by collar exhaust fumes for a vertical connection , anyway it's possible also the back connection.

Vertical exhaust fumes collar

- Place the collar over the plate (Fig.1) and fix it to the plate employing the enclosed screws. Be careful to employ the screws in the right way.

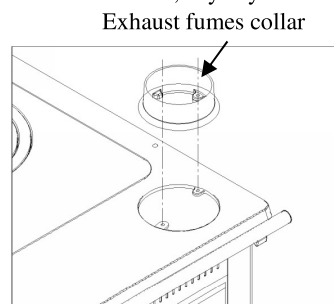

Fig. 1