

## SECURITY DISTANCES

- From NOT combustible object :
  - A > 400 mm      B > 200 mm      C > 250 mm      D > 1500 mm
- From combustible object and from principal wall in rein forced concrete :
  - A > 800 mm      B > 400 mm      C > 500 mm      D > 1500 mm
- The minimal distance between the appliance and every flammable object around it is 1.5 meter.

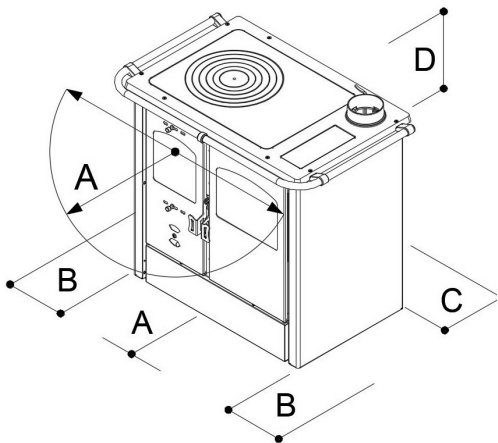
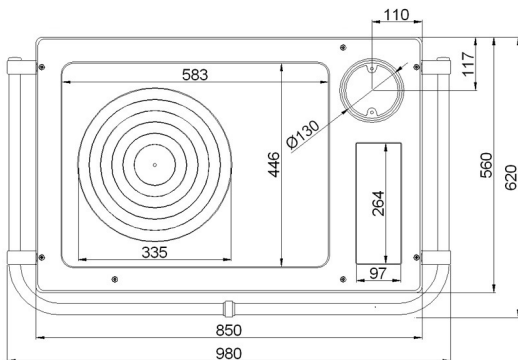

To measure from external side of the equipment

## 1.4 Connection

- Before connection check technical data reported in the technical plate ( Chap. 4 ) and control that it correspond to the ones required in the order.
- All heating biomass equipment especially wood appliance has to evacuate the combustion products in a flue built in conformity with normative in force.
- The following instructions describes „ informations for a good installation „ and it refers to a normative in force but it are not to be consider exhaustive for installations laws.